

# Cynigion prif fap INM Proposed routes

Produced by the Active Travel web site. Gynhyrchwyd gan y wefan Teithio Llesol.

Yr Amgylchedd  
Ffyrdd a Chyfleusterau / Environment  
Roads & Facilities



## Legend / Eglurhad

### Active Travel Routes / Llwybrau Teithio Llesol

- Undefined path design / Dyluniad llwybr heb ei ddiffinio
- Footpath (away from road) / Llwybr troed (i ffordd o'r ffordd)
- Footway (alongside road) / Troedffordd (ochr yn ochr â ffordd)
- Cycle track (away from road) / Trac beicio (i ffordd o'r ffordd)
- Cycle track (alongside road) / Trac beicio (ochr yn ochr â ffordd)
- Shared use foot/cycle path (away from road) / Llwybr cerdded/beicio a rennir (i ffordd o'r ffordd)
- Shared use foot/cycle path (alongside road) / Llwybr cerdded/beicio a rennir (ochr yn ochr â ffordd)
- Segregated foot/cycle path (away from road) / Llwybr cerdded/beicio wedi'i wahanu (i ffordd o'r ffordd)
- Segregated foot/cycle path (alongside road) / Llwybr cerdded/beicio wedi'i wahanu (ochr yn ochr â ffordd)
- Cycle route (on road, not segregated) / Lôn feicio (ar y ffordd, heb ei gwahanu)
- Cycle lane (on road, segregated) / Lôn feicio (ar y ffordd, wedi'i gwahanu)
- Pedestrian zone / Ardal cerdded
- Pedestrian and cycle zone / Ardal cerdded a beicio
- Road without footway / Ffordd heb droedffordd
- Line end points / Pwyntiau diwedd llinell
- Advanced Stop Lines / Llinellau Stopio Blaen
- Crossings / Croesfannau



Suggested route linking Deganwy to Llandudno

Suggested routes linking to new school site in Llandudno Junction

© Crown Copyright and database right 2014. Ordnance Survey 100021874. Welsh Government. © Hawlfraint a hawliau cronfa ddata'r Goron 2014. Rhif Trwydded yr Arolwg Ordnans 100021874. Whilst the Welsh Government have made every effort to ensure that the information on this website is accurate and up-to-date, the Welsh Government takes no responsibility for any incorrect information. The data is compiled from Public Rights of Way, Ordnance Survey ITN, Ordnance Survey ITN Urban Path and aerial photography derived data supplemented by field survey. The online map is provided for guidance only and is not a legal record. Er bod Llywodraeth Cymru wedi gwneud pob ymdrech i sicrhau bod y wybodaeth ar y wefan hon yn gywir ac yn gyfredol, mae Llywodraeth Cymru yn cymryd unrhyw gyfrifoldeb am unrhyw wybodaeth anghywir. Lluniwyd y data o hawliau tramwy cyhoeddus, RhTI yr AO, Llwybrau Trefol RhTI yr AO a data sy'n deillio o ffotograffau o'r awyr wedi'i ategu gan arolwg maes. Yn y map ar-lein yn darparu canllaw yn unig ac nid yw cofnod cyfreithiol.





# Cynnig llwybr INM proposals

Produced by the Active Travel web site. Gynhyrchwyd gan y wefan Teithio Llesol.

Yr Amgylchedd  
Ffyrdd a Chyfleusterau / Environment  
Roads & Facilities

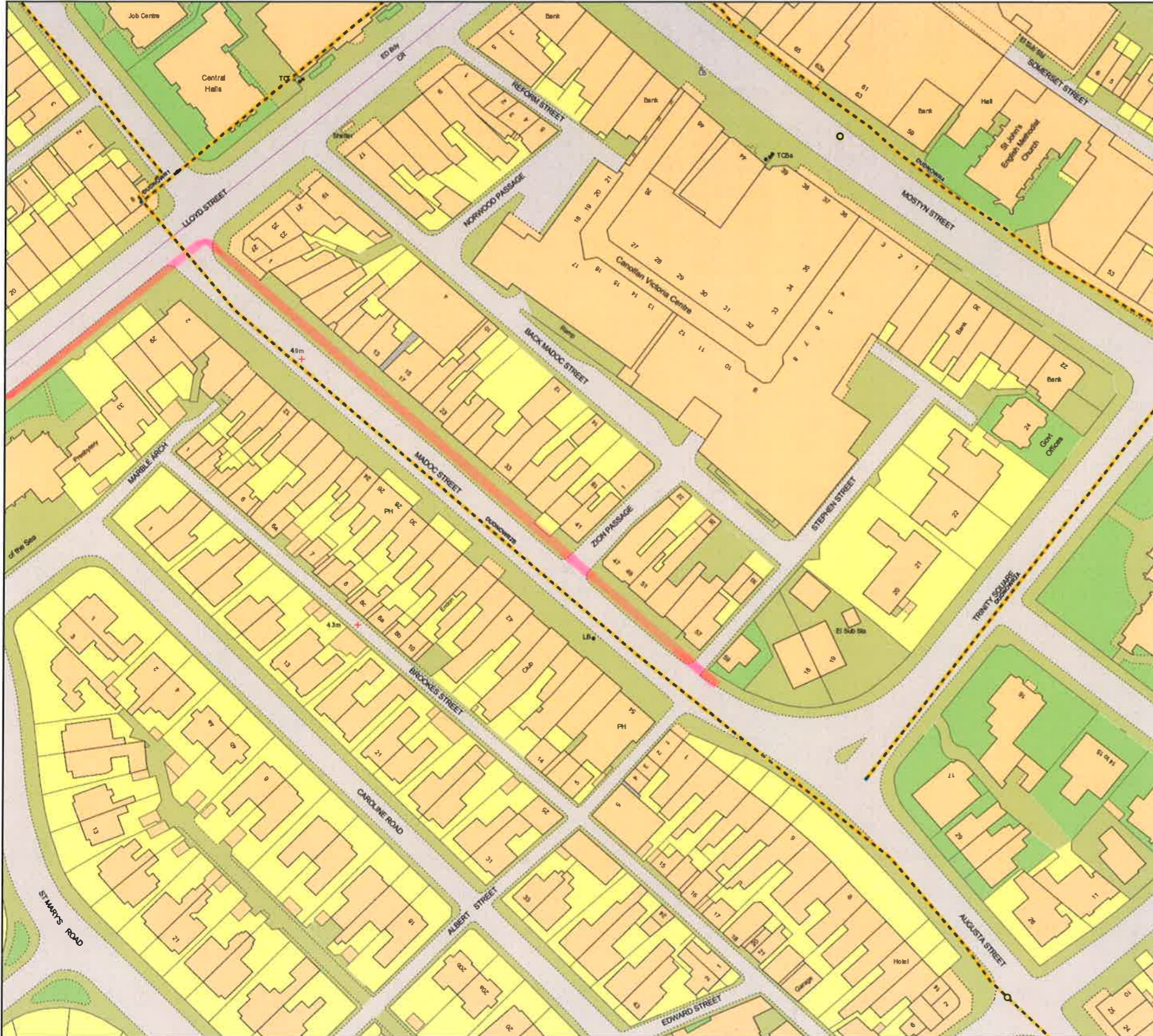

## Legend / Eglurhad

### Active Travel Routes / Llwybrau Teithio Llesol

- Undefined path design / Dyluniad llwybr heb ei ddiffinio
- Footpath (away from road) / Llwybr troed (i ffwrdd o'r ffordd)
- Footway (alongside road) / Troedffordd (ochr yn ochr â ffordd)
- Cycle track (away from road) / Trac beicio (i ffwrdd o'r ffordd)
- Cycle track (alongside road) / Trac beicio (ochr yn ochr â ffordd)
- Shared use foot/cycle path (away from road) / Llwybr cerdded/beicio a rennir (i ffwrdd o'r ffordd)
- Shared use foot/cycle path (alongside road) / Llwybr cerdded/beicio a rennir (ochr yn ochr â ffordd)
- Segregated foot/cycle path (away from road) / Llwybr cerdded/beicio wedi'i wahanu (i ffwrdd o'r ffordd)
- Segregated foot/cycle path (alongside road) / Llwybr cerdded/beicio wedi'i wahanu (ochr yn ochr â ffordd)
- Cycle route (on road, not segregated) / Lôn feicio (ar y ffordd, heb ei gwahanu)
- Cycle lane (on road, segregated) / Lôn feicio (ar y ffordd, wedi'i gwahanu)
- Pedestrian zone / Ardal cerdded
- Pedestrian and cycle zone / Ardal cerdded a beicio
- Road without footway / Ffordd heb droedffordd
- Line end points / Pwyntiau diwedd llinell
- Integrated Network / Rhwydwaith Integredig
- Crossings / Croesfannau



Suggested cycle path  
Madoc St and Lloydd St

© Crown Copyright and database right 2014. Ordnance Survey 100021874. Welsh Government. © Hawlfraint a hawliau cronfa ddata'r Goron 2014. Rhif Trwydded yr Arolwg Ordnans 100021874. Whilst the Welsh Government have made every effort to ensure that the information on this website is accurate and up-to-date, the Welsh Government takes no responsibility for any incorrect information. The data is compiled from Public Rights of Way, Ordnance Survey ITN, Ordnance Survey ITN Urban Path and aerial photography derived data supplemented by field survey. The online map is provided for guidance only and is not a legal record. Er bod Llywodraeth Cymru wedi gwneud pob ymdrech i sicrhau bod y wybodaeth ar y wefan hon yn gywir ac yn gyfredol, mae Llywodraeth Cymru yn cymryd unrhyw gyfrifoldeb am unrhyw wybodaeth anghywir. Lluniwyd y data o hawliau tramwy cyhoeddus, RhTI yr AO, Llwybrau Trefol RhTI yr AO a data sy'n deillio o ffotograffau o'r awyr wedi'i ategu gan arolwg maes. Yn y map ar-lein yn darparu canllaw yn unig ac nid yw cofnod cyfreithiol.





# Cynigion prif fap INM proposed route improvement

Produced by the Active Travel web site. Gynhyrchwyd gan y wefan Teithio Llesol.

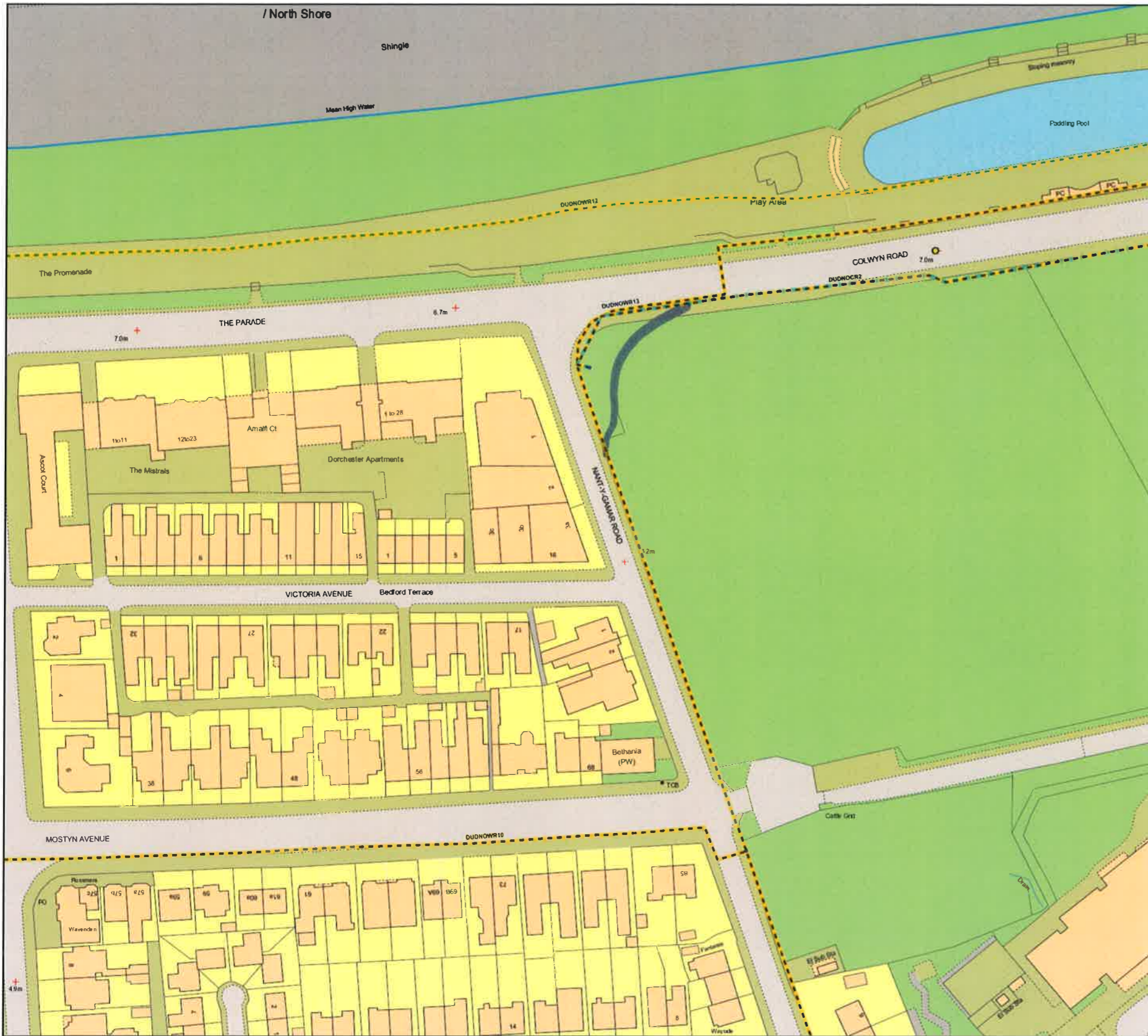

## Legend / Eglurhad

### Active Travel Routes / Llwybrau Teithio Llesol

- Undefined path design / Dyluniad llwybr heb ei ddiffinio
  - Footpath (away from road) / Llwybr troed (i ffwrdd o'r ffordd)
  - Footway (alongside road) / Troedffordd (ochr yn ochr â ffordd)
  - Cycle track (away from road) / Trac beicio (i ffwrdd o'r ffordd)
  - Cycle track (alongside road) / Trac beicio (ochr yn ochr â ffordd)
  - Shared use foot/cycle path (away from road) / Llwybr cerdded/beicio a rennir (i ffwrdd o'r ffordd)
  - Shared use foot/cycle path (alongside road) / Llwybr cerdded/beicio a rennir (ochr yn ochr â ffordd)
  - Segregated foot/cycle path (away from road) / Llwybr cerdded/beicio wedi'i wahanu (i ffwrdd o'r ffordd)
  - Segregated foot/cycle path (alongside road) / Llwybr cerdded/beicio wedi'i wahanu (ochr yn ochr â ffordd)
  - Cycle route (on road, not segregated) / Lôn feicio (ar y ffordd, heb ei gwahanu)
  - Cycle lane (on road, segregated) / Lôn feicio (ar y ffordd, wedi'i gwahanu)
  - Pedestrian zone / Ardal cerdded
  - Pedestrian and cycle zone / Ardal cerdded a beicio
  - Road without footway / Ffordd heb droedffordd
- 
- Line end points / Pwyntiau diwedd llinell
  - Integrated Network / Rhwydwaith Integredig
  - Advanced Stop Lines / Llinellau Stopio Blaen
  - Crossings / Croesfannau



**Suggested INM improvement. Junction of Nant-y-Gammar Rd and Colwyn Road**

© Crown Copyright and database right 2014. Ordnance Survey 100021874. Welsh Government. © Hawlfraint a hawliau cronfa ddata'r Goron 2014. Rhif Trwydded yr Arolwg Ordnans 100021874. Whilst the Welsh Government have made every effort to ensure that the information on this website is accurate and up-to-date, the Welsh Government takes no responsibility for any incorrect information. The data is compiled from Public Rights of Way, Ordnance Survey ITN, Ordnance Survey ITN Urban Path and aerial photography derived data supplemented by field survey. The online map is provided for guidance only and is not a legal record. Er bod Llywodraeth Cymru wedi gwneud pob ymdrech i sicrhau bod y wybodaeth ar y wefan hon yn gywir ac yn gyfredol, mae Llywodraeth Cymru yn cymryd unrhyw gyfrifoldeb am unrhyw wybodaeth anghywir. Lluniwyd y data o hawliau tramwy cyhoeddus, RhTI yr AO, Llwybrau Trefol RhTI yr AO a data sy'n deillio o ffotograffau o'r awyr wedi'i ategu gan arolwg maes. Yn y map ar-lein yn darparu canllaw yn unig ac nid yw cofnod cyfreithiol.



# Cynnig llwybr INM Route proposal

Produced by the Active Travel web site. Gynhyrchwyd gan y wefan Teithio Llesol.

Yr Amgylchedd  
Ffyrdd a Chyfleusterau / Environment  
Roads & Facilities

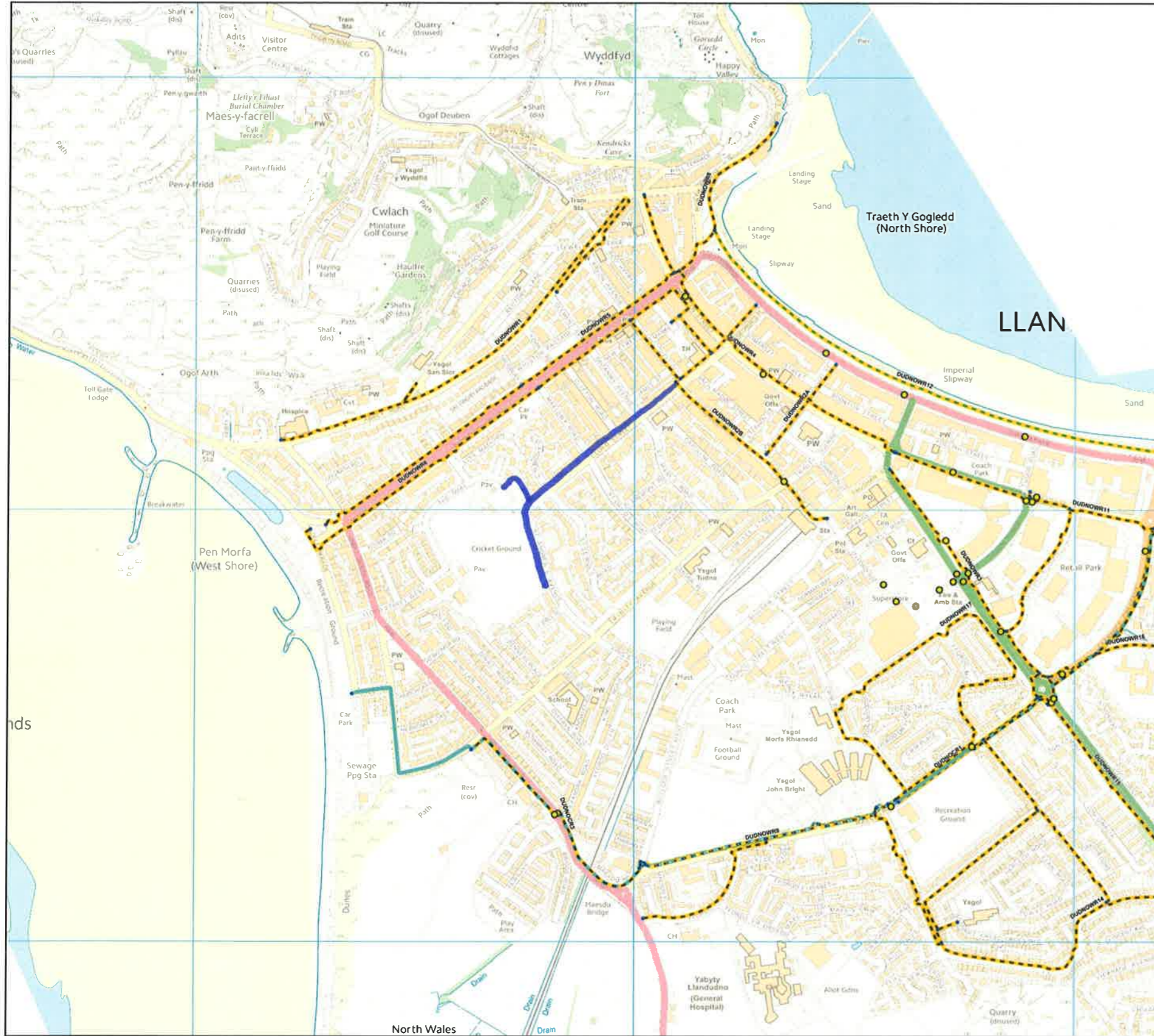

## Legend / Eglurhad

### Active Travel Routes / Llwybrau Teithio Llesol

- Undefined path design / Dyluniad llwybr heb ei ddiffinio
- Footpath (away from road) / Llwybr troed (i ffwrdd o'r ffordd)
- Footway (alongside road) / Troedffordd (ochr yn ochr â ffordd)
- Cycle track (away from road) / Trao beicio (i ffwrdd o'r ffordd)
- Cycle track (alongside road) / Trao beicio (ochr yn ochr â ffordd)
- Shared use foot/cycle path (away from road) / Llwybr oerdded/beicio a rennir (i ffwrdd o'r ffordd)
- Shared use foot/cycle path (alongside road) / Llwybr oerdded/beicio a rennir (ochr yn ochr â ffordd)
- Segregated foot/cycle path (away from road) / Llwybr oerdded/beicio wed'i wahanu (i ffwrdd o'r ffordd)
- Segregated foot/cycle path (alongside road) / Llwybr oerdded/beicio wed'i wahanu (ochr yn ochr â ffordd)
- Cycle route (on road, not segregated) / Lôn feicio (ar y ffordd, heb ei gwahanu)
- Cycle lane (on road, segregated) / Lôn feicio (ar y ffordd, wed'i gwahanu)
- Pedestrian zone / Ardal oerdded
- Pedestrian and cycle zone / Ardal oerdded a beicio
- Road without footway / Ffordd heb droedffordd
- Line end points / Pwyntiau diwedd llinell
- Integrated Network / Rhwydwaith Integredig
- Advanced Stop Lines / Llinellau Stopio Blaen
- Crossings / Croesfannau



**— Suggested footway/cycleway  
Lloyd St (linking Madoc St to  
playing fields)**

© Crown Copyright and database right 2014. Ordnance Survey 100021874. Welsh Government. © Hawlfraint a hawliau cronfa ddata'r Goron 2014. Rhif Trwydded yr Arolwg Ordnans 100021874. Whilst the Welsh Government have made every effort to ensure that the information on this website is accurate and up-to-date, the Welsh Government takes no responsibility for any incorrect information. The data is compiled from Public Rights of Way, Ordnance Survey ITN, Ordnance Survey ITN Urban Path and aerial photography derived data supplemented by field survey. The online map is provided for guidance only and is not a legal record. Er bod Llywodraeth Cymru wedi gwneud pob ymdrech i sicrhau bod y wybodaeth ar y wefan hon yn gywir ac yn gyfredol, mae Llywodraeth Cymru yn cymryd unrhyw gyfrifoldeb am unrhyw wybodaeth anghywir. Lluniwyd y data o hawliau tramwy cyhoeddus, RhTI yr AO, Llwybrau Trefol RhTI yr AO a data sy'n deillio o ffotograffau o'r awyr wedi'i ategu gan arolwg maes. Yn y map ar-lein yn darparu canllaw yn unig ac nid yw cofnod cyfreithiol.





Mynedfa gefn i mewn i Mostyn Champneys i osgoi mynedfa brysur i gerbydau  
Rear entrance into Mostyn Champneys to avoid busy vehicle entrance



© 2016 Google  
© 2017 Google

Google earth







© 2016 Google

© 2017 Google

Google earth





Llwybr beicio Maesdu Road yn dod i ben yn y maes chwarae / Maesdu Road cycle route discontinues at recreational ground





**Existing Path Layers / Haenau Llwybr Presennol**

- Restrictions / Cyfyngiadau
- Crossings / Croesfannau
- Advanced Stop Lines / Llinellau Stopio Blaen
- Related Facilities / Cysyllterau Cysylltiedig
- Path Links / Cysylltiadau Llwybrau

**Active Travel Layers / Haenau Teithio Llesol**

- Integrated Network / Rhwydwaith Integredig

Llwybr Map Rhwydwaith Integredig a awgrymir

Suggested INM route

All data is for use in preparing Active Travel Routes and Integrated Network and is not suitable for use for other purposes.  
 Dylai'r holl ddata gael ei ddefnyddio i baratoi Llwybrau Teithio Llesol a Rhwydwaith Integredig. Nid yw'n addas at ddibenion eraill.

Designed by exeGesIS SDM Ltd 2015. Dyluniwyd gan exeGesIS SDM Ltd 2015





© 2016 Google  
© 2017 Google

Google earth

Google earth

feet  
meters





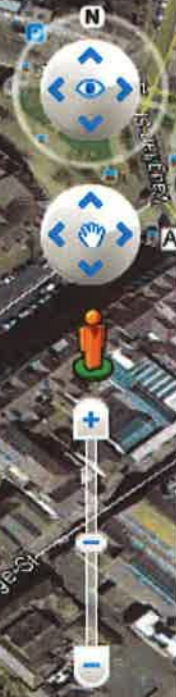



File Edit View Document Comments Form Object Tools Advanced SharePoint Window Help
Open... Print Copy Paste Undo Redo 33.54% Edit Content Edit Comments Highlight, Strikeout, Underline, Sticky Note, Sound, Stamp

Tiethio Llesol - Llandudno
Produced by the Active Travel web site. Gynhyrchwyd gan y wefan Tethio Llesol.



Legend / Eglurhad
Active Travel Route / Lloegr Tethio Llesol
Highlighted path design / Ffordd Tethio Llesol yn ddifrifus
Proposed paths from road to road / Ffordd Tethio Llesol yn ddifrifus

© Crown Copyright and database right 2016. Ordnance Survey 100024076. Welsh Government. © Heddwen a Heulwen urddor 2016. All rights reserved by Heddwen a Heulwen urddor 2016.



Options... W: 841.0mm H: 594.0mm 1/1 Launch: [icon]

Windows taskbar: Start button, Active Travel (Wal...), Calendar - Mailbo..., erm\_llandudno\_..., 11:59, 30/01/2017



File Edit View Document Comments Form Object Tools Advanced SharePoint Window Help

Open... Print... 33.54% Edit Content Edit Comments Highlight, Strikeout, Underline, Sticky Note, Sound, Stamp

Exclusive Mode Properties...

**Tiethio Llesol - Llandudno**  
Produced by the Active Travel web site. Gynhyrchwyd gan y wefan Tethio Llesol.

**CONWY**  
CONYR BRENEDOL IWO  
CONYR BRENEDOL IWO  
CONYR BRENEDOL IWO

**Legend / Eglurhad**

- Active Travel Route / Lloegr Tethio Llesol
- Segregated path (cycle) / Ffyrdded Bectio heb yr awdurdod
- Segregated path (pedestrian) / Ffyrdded Pedestrian heb yr awdurdod
- Segregated path (shared) / Ffyrdded Goleuadau heb yr awdurdod
- Segregated path (cycle) / Ffyrdded Bectio heb yr awdurdod
- Segregated path (pedestrian) / Ffyrdded Pedestrian heb yr awdurdod
- Segregated path (shared) / Ffyrdded Goleuadau heb yr awdurdod
- Segregated path (cycle) / Ffyrdded Bectio heb yr awdurdod
- Segregated path (pedestrian) / Ffyrdded Pedestrian heb yr awdurdod
- Segregated path (shared) / Ffyrdded Goleuadau heb yr awdurdod
- Segregated path (cycle) / Ffyrdded Bectio heb yr awdurdod
- Segregated path (pedestrian) / Ffyrdded Pedestrian heb yr awdurdod
- Segregated path (shared) / Ffyrdded Goleuadau heb yr awdurdod
- Segregated path (cycle) / Ffyrdded Bectio heb yr awdurdod
- Segregated path (pedestrian) / Ffyrdded Pedestrian heb yr awdurdod
- Segregated path (shared) / Ffyrdded Goleuadau heb yr awdurdod
- Line and cycle / Ffyrdded a Bectio
- Shared Space / Ffyrdded Goleuadau
- Changes / Cymrwahan
- Related Facilities / Cylffwrdd Cymru

© Crown Copyright and database right 2016, Ordnance Survey 100020176. Welsh Government. © Heddwyn a Ffynnon ynghyd â'r Gwasanaethau Cymunedol a'r Gwasanaethau Cymunedol. All rights reserved. This information is provided for guidance only and is not a legal document. The Welsh Government does not make any warranty or guarantee that the information on this website is accurate and up-to-date. The Welsh Government takes no responsibility for any incorrect information. The data is compiled from Public Rights of Way, Ordnance Survey 1:25,000 Scale Vector Data and aerial photography derived data supplemented by field surveys. The online map is provided for guidance only and is not a legal document. The Welsh Government does not make any warranty or guarantee that the information on this website is accurate and up-to-date. The Welsh Government takes no responsibility for any incorrect information. The data is compiled from Public Rights of Way, Ordnance Survey 1:25,000 Scale Vector Data and aerial photography derived data supplemented by field surveys. The online map is provided for guidance only and is not a legal document. © Crown Copyright and database right 2016, Ordnance Survey 100020176. Welsh Government. © Heddwyn a Ffynnon ynghyd â'r Gwasanaethau Cymunedol a'r Gwasanaethau Cymunedol. All rights reserved. This information is provided for guidance only and is not a legal document. The Welsh Government does not make any warranty or guarantee that the information on this website is accurate and up-to-date. The Welsh Government takes no responsibility for any incorrect information. The data is compiled from Public Rights of Way, Ordnance Survey 1:25,000 Scale Vector Data and aerial photography derived data supplemented by field surveys. The online map is provided for guidance only and is not a legal document. © Crown Copyright and database right 2016, Ordnance Survey 100020176. Welsh Government. © Heddwyn a Ffynnon ynghyd â'r Gwasanaethau Cymunedol a'r Gwasanaethau Cymunedol. All rights reserved. This information is provided for guidance only and is not a legal document. The Welsh Government does not make any warranty or guarantee that the information on this website is accurate and up-to-date. The Welsh Government takes no responsibility for any incorrect information. The data is compiled from Public Rights of Way, Ordnance Survey 1:25,000 Scale Vector Data and aerial photography derived data supplemented by field surveys. The online map is provided for guidance only and is not a legal document.

13 May 2016 10:14 AM









© 2016 Google

Google earth