

Croesfan pen gwastad wedi'i godi  
Raised flat top crossing point

Lledu arfaethedig i ymyl y ffordd  
Trosir i ddefnydd a rennir

Proposed widening into verge  
Convert to shared use



Gwaith sy'n flaenoriaeth  
Ffordd gerbydau wedi ei chulhau i arafu  
traffig ac atal pobl rhag defnyddio  
strydoedd preswyl ar adegau prysur

Priority working  
Narrowed carriageway to to keep  
speeds low and deter 'rat-running'

Triniaeth ymuno i'r ffordd ymyl  
Side Road entry treatment



Newid y groesfan  
sebra presennol i  
groesfan baralel

Existing zebra crossing  
to be changed to  
parallel crossing  
(DE611)

Lledu'r droetffordd i 3m  
Trosir i ddefnydd a rennir (DE024)

Symud lleoedd parcio gyda  
chyfyngiadau aros  
Cyfyngiadau parcio 24  
awrfaethedig

Widen footway to 3m  
Convert to shared use (DE024)

Remove Limited Waiting parking  
Proposed 24hr parking restrictions

Cyfyngiadau parcio i'r de  
Parking restriction to the south

Symud y groesfan  
Crossing removed

Croesfan pen gwastad wedi'i godi  
Man cyfyng a lledu'r droetffordd  
tu allan Ysgol C-Y-D

Raised flat top crossing point  
Pinch point and widen footway  
outside C-Y-D school

Lledu'r droetffordd i 3m  
Trosir i ddefnydd a rennir (DE024)  
Widen footway to 3m  
Convert to shared use (DE024)

GENERAL NOTES

- G1. DO NOT SCALE THIS DRAWING.
- G2. ANY DIMENSIONAL DISCREPANCIES SHOULD BE NOTIFIED TO THE ENGINEER IMMEDIATELY.
- G3. ALL DIMENSIONS ARE IN MILLIMETRES - (mm)  
ALL LEVELS ARE IN METRES - (m) AND ARE ABOVE ORDNANCE DATUM AT NEWLYN, CORNWALL UNLESS NOTED OTHERWISE.
- G4. NORTH SHOWN INDICATIVE ONLY
- G5. THIS DRAWING IS TO BE READ IN CONJUNCTION WITH ALL RELEVANT SPECIFICATIONS, DRAWINGS, DETAILS AND OTHER DESIGN INFORMATION.
- G6. ALL DRAWINGS AND WRITTEN MATERIAL CONTAINED WITHIN, CONSTITUTE ORIGINAL AND UNPUBLISHED WORK OF THE ENGINEER AND MAY NOT BE DUPLICATED, USED, REPRODUCED OR DISCLOSED WITHOUT WRITTEN CONSENT OR EXPRESS PERMISSION FROM THE ENGINEER.
- G7. ALL INFORMATION CONTAINED IN THIS DOCUMENT IS COPYRIGHT ©
- G8. WHERE THE CONTRACTOR UNDERTAKES OR ENGAGES A THIRD PARTY TO UNDERTAKE TEMPORARY WORKS DESIGN, OR VARIES THE PELL FRISCHMANN DESIGN IN ANY WAY, THEN THE CONTRACTOR WILL TAKE FULL RESPONSIBILITY AND LIABILITY FOR ALL DESIGN ASPECTS, INCLUDING A DESIGN RISK ASSESSMENT. THE CONTRACTOR SHALL INFORM PELL FRISCHMANN OF ANY PROPOSED VARIANCES TO THE DESIGN.
- G9. DETAIL NUMBERS REFER TO WELSH GOVERNMENTS ACTIVE TRAVEL GUIDANCE (JULY 2021)

ALLWEDD KEY

- CURB NEWYDD ARFAETHEDIG  
PROPOSED NEW KERB
- CURB YMYL NEWYDD ARFAETHEDIG  
PROPOSED NEW EDGE KERB

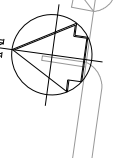

Dechrau stryd dawel  
Croesfan pen gwasas wedi'i godi a'r  
marciau ffordd symbol beicio

Quiet Street Starts  
Raised flat top crossing point and cycle  
symbol road markings

Gosod twmpathau cyflymder  
i arafu traffig ac atal pobl  
rhag defnyddio strydoedd  
preswyl ar adegau prysur

Speed humps to keep speeds  
low and deter 'rat-running'



Croesfan isel  
Dropped crossing point

Croesfan pen gwasas wedi'i godi  
a'r marciau ffordd symbol beicio

Raised flat top crossing point and  
cycle symbol road markings

Croesfan pen gwastad wedi'i godi  
Tynhau radiysau  
Raised flat top crossing point  
Tighten radii

Lled ffordd annigonol ar gyfer lledu'r droetffordd sydd i'r de  
Insufficient Road width for widening of south footway

Cynnal y mynediad preifat  
Croesfan isel

Private access to be maintained  
Dropped crossing point

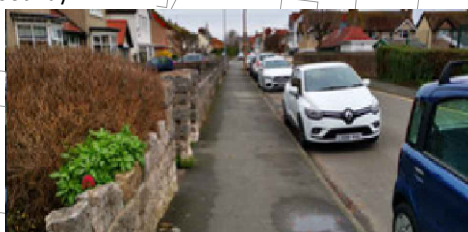

Lleihau'r cilfan i ledu'r droetffordd sydd ar gael i gerddwyr wrth ymyl mynediad yr ysgol fabanod  
Layby to be reduced to increase footway available for pedestrians near infant school access

REV	DESCRIPTION	DRN	CHK	APP	DATE
-----	-------------	-----	-----	-----	------

**Pell Frischmann**

PICCADILLY HOUSE, 49 PICCADILLY, MANCHESTER M1 2AP  
Telephone +44 (0)161 826 9400  
Email: pfrischmann@pellfrischmann.com  
www.pellfrischmann.com

Architect/Client/Contractor

**CRAIG Y DON  
TEITHIO LLESOL  
ACTIVE TRAVEL**

Drawing Title  
**AT DDBENION ENGHREIFFTIOL YN UNIG  
ILLUSTRATION PURPOSES ONLY  
TUDALEN / SHEET 1 / 2**

Drawing Status  
**WORK IN PROGRESS**

Name	Date	Status Code
Drawn E.PAINTER	07.04.22	S0
Designed E.PAINTER	07.04.22	Scale 1:500
Eng Chk		Revision
Approved		P01-CCBC.2

Drawing No. 106077 - PEL-HGN-06 - SK - D - 0001

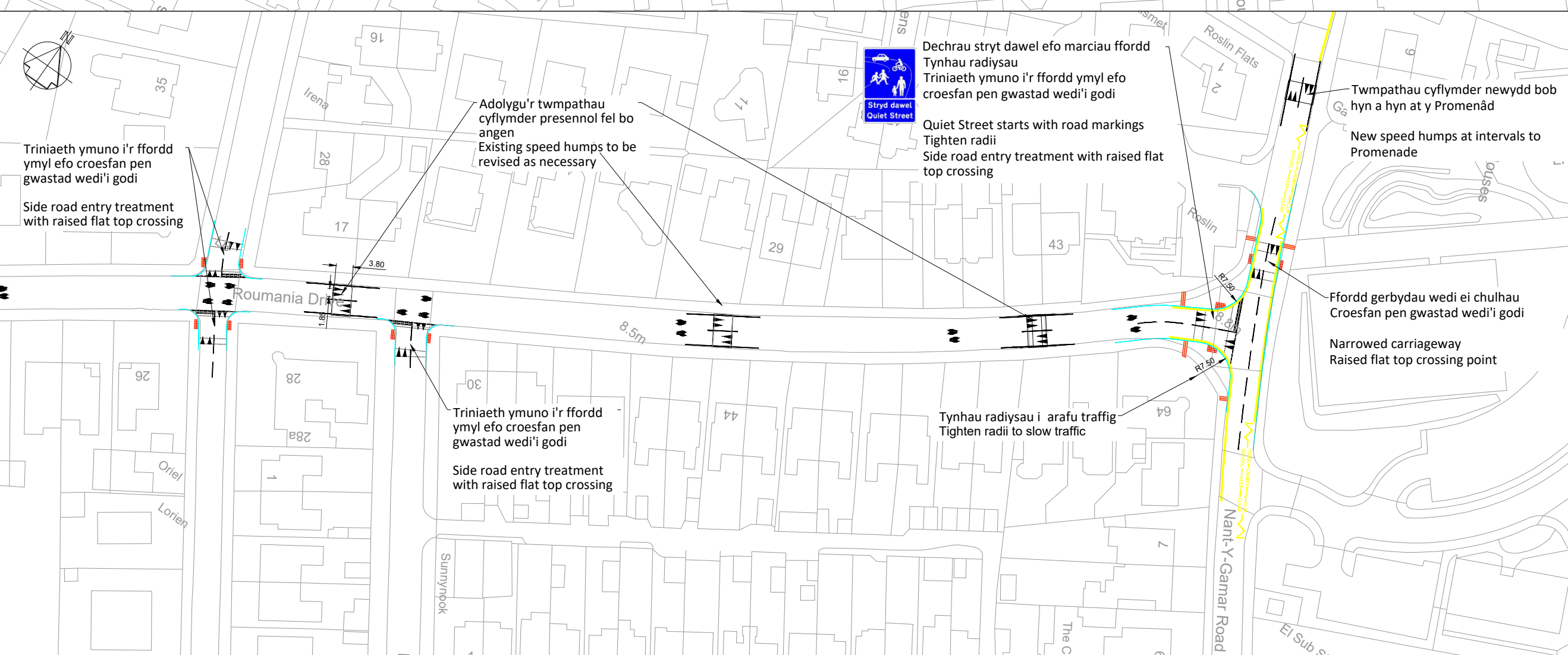
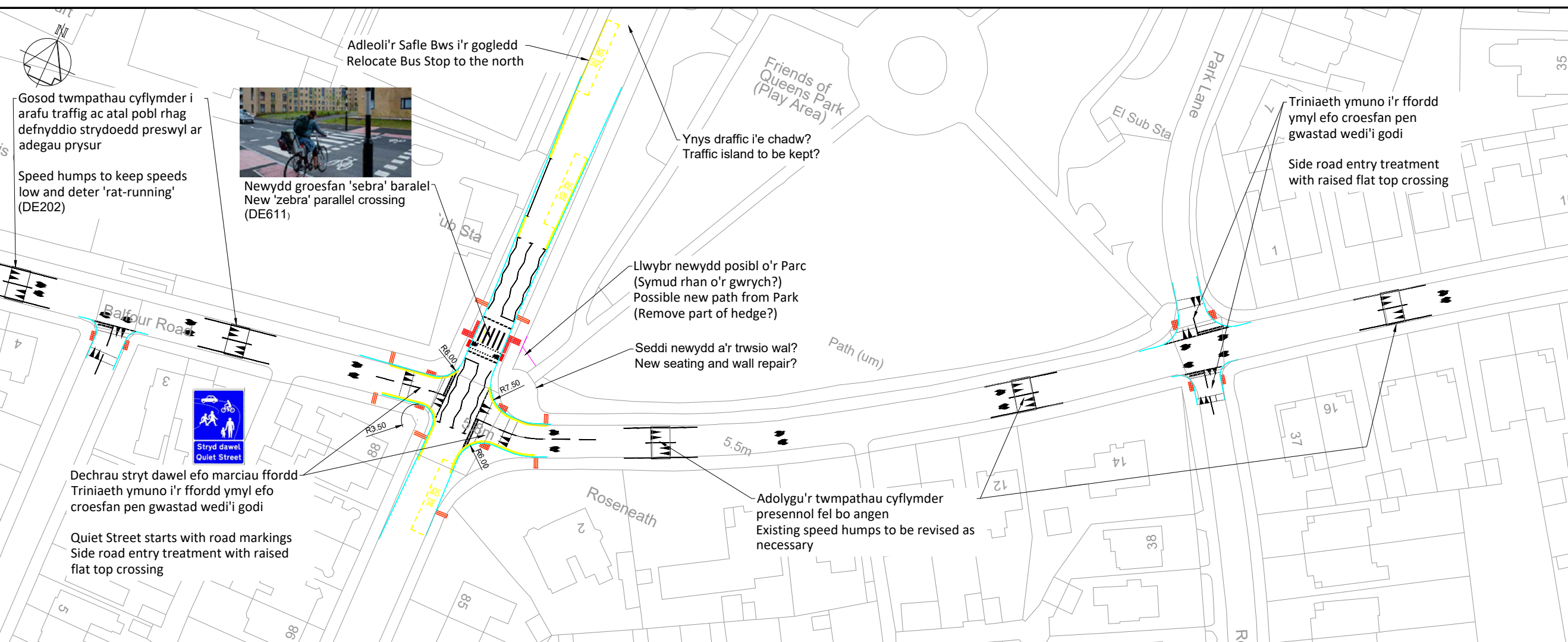

- GENERAL NOTES**
- G1. DO NOT SCALE THIS DRAWING.
  - G2. ANY DIMENSIONAL DISCREPANCIES SHOULD BE NOTIFIED TO THE ENGINEER IMMEDIATELY.
  - G3. ALL DIMENSIONS ARE IN MILLIMETRES - (mm)  
ALL LEVELS ARE IN METRES - (m) AND ARE ABOVE ORDNANCE DATUM AT NEWLYN. CORNWALL UNLESS NOTED OTHERWISE.
  - G4. NORTH SHOWN INDICATIVE ONLY
  - G5. THIS DRAWING IS TO BE READ IN CONJUNCTION WITH ALL RELEVANT SPECIFICATIONS, DRAWINGS, DETAILS AND OTHER DESIGN INFORMATION.
  - G6. ALL DRAWINGS AND WRITTEN MATERIAL CONTAINED WITHIN, CONSTITUTE ORIGINAL AND UNPUBLISHED WORK OF THE ENGINEER AND MAY NOT BE DUPLICATED, USED, REPRODUCED OR DISCLOSED WITHOUT WRITTEN CONSENT OR EXPRESS PERMISSION FROM THE ENGINEER.
  - G7. ALL INFORMATION CONTAINED IN THIS DOCUMENT IS COPYRIGHT ©
  - G8. WHERE THE CONTRACTOR UNDERTAKES OR ENGAGES A THIRD PARTY TO UNDERTAKE TEMPORARY WORKS DESIGN, OR VARIES THE PELL FRISCHMANN DESIGN IN ANY WAY, THEN THE CONTRACTOR WILL TAKE FULL RESPONSIBILITY AND LIABILITY FOR ALL DESIGN ASPECTS, INCLUDING A DESIGN RISK ASSESSMENT. THE CONTRACTOR SHALL INFORM PELL FRISCHMANN OF ANY PROPOSED VARIANCES TO THE DESIGN.
  - G9. DETAIL NUMBERS REFER TO WELSH GOVERNMENTS ACTIVE TRAVEL GUIDANCE (JULY 2021)

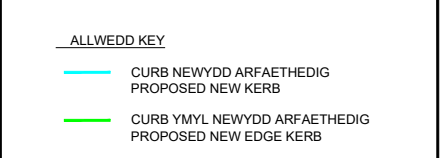

REV	DESCRIPTION	DRN	CHK	APP	DATE

**Pell Frischmann**  
PICCADILLY HOUSE, 49 PICCADILLY, MANCHESTER M1 2AP  
Telephone +44 (0)161 826 9400  
Email: pfrmanchester@pellfrischmann.com  
www.pellfrischmann.com

Architect/Client/Contractor

Project

**CRAIG Y DON  
TEITHIO LLESOL  
ACTIVE TRAVEL**

Drawing Title

**AT DDIBENION ENGHREIFFTIOL YN UNIG  
ILLUSTRATION PURPOSES ONLY  
SHEET 2 OF 2**

Drawing Status

**WORK IN PROGRESS**

Name	Date	Status Code
Drawn E.PAINTER	07.04.22	S0
Designed E.PAINTER	07.04.22	Scale N.T.S
Eng Chk		Revision P01
Approved		

Drawing No.

**106077 · PEL HGN-06 · SK · D · 0002**

© Pell Frischmann Consultants IA1 R415/504